



Topic 3. ITS and C-ITS applications and user services

Igor Kabashkin

Professor, Dr.hab.sc.ing.

Transport and Telecommunication Institute (Riga, Latvia)

ITS Functional Areas

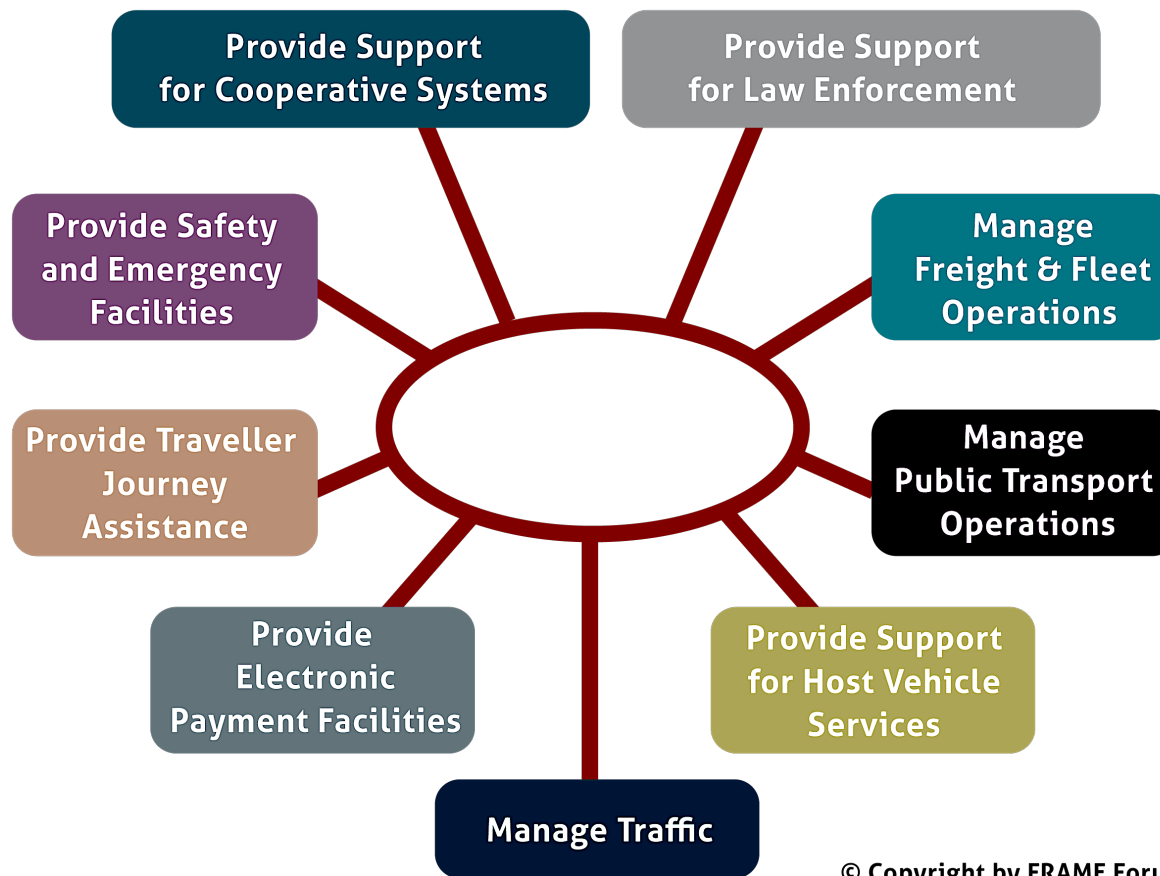

© Copyright by FRAME Forum

In accordance of international standard ISO/TR 14813-2 there are 32 ITS services in 8 category.

| Service Category | Service Number | Service Name |
|-----------------------|----------------|---|
| Traveller Information | 1 | Pre-trip Information |
| | 2 | On-trip Driver Information |
| | 3 | On-trip Public Transport Information |
| | 4 | Personal Information Services |
| | 5 | Route Guidance and Navigation |
| Traffic Management | 6 | Transportation Planning Support |
| | 7 | Traffic Control |
| | 8 | Incident Management |
| | 9 | Demand Management |
| | 10 | Policing/Enforcing Traffic Regulations |
| | 11 | Infrastructure Maintenance Management |
| Vehicle | 12 | Vision Enhancement |
| | 13 | Automated Vehicle Operation |
| | 14 | Longitudinal Collision Avoidance |
| | 15 | Lateral Collision Avoidance |
| | 16 | Safety Readiness |
| | 17 | Pre-crash Restraint Deployment |
| Commercial Vehicle | 18 | Commercial Vehicle Pre-clearance |
| | 19 | Commercial Vehicle Administrative Processes |
| | 20 | Automated Roadside Safety Inspection |
| | 21 | Commercial Vehicle On-board Safety Monitoring |
| | 22 | Commercial Vehicle Fleet Management |
| Public Transport | 23 | Public Transport Management |
| | 24 | Demand Responsive Transport Management |
| | 25 | Shared Transport Management |
| Emergency | 26 | Emergency Notification and Personal Security |
| | 27 | Emergency Vehicle Management |
| | 28 | Hazardous Materials and Incident Notification |
| Electronic Payment | 29 | Electronic Financial Transactions |
| Safety | 30 | Public Travel Security |
| | 31 | Safety Enhancement for Vulnerable Road Users |
| | 32 | Intelligent Junctions and Links |

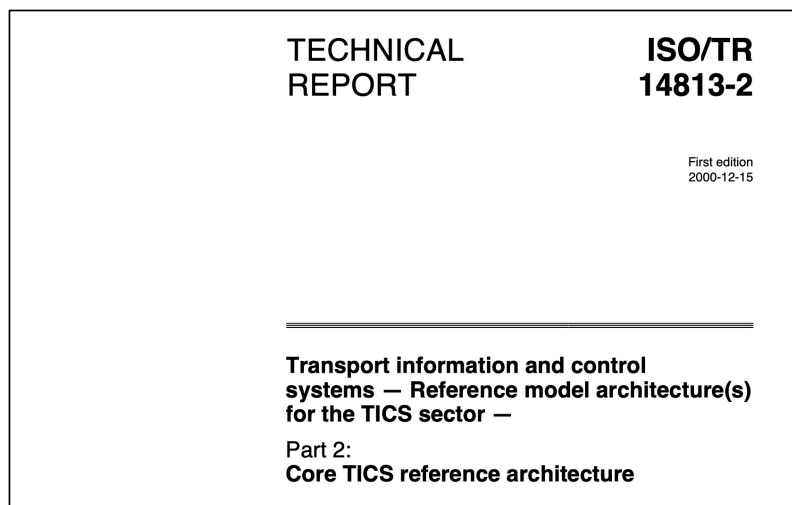

In accordance of international standard ISO/TR 14813-2 there are 32 ITS services in 8 category (see section 3 of the course). But national ITS architectures can include additional services and functions which are not listed in ISO taxonomy of services. Each functional area consists of interrelated services.

For example, the US national architecture has 33 user services in eight User Service Bundles. There is a strong emphasis on the activities of public agencies and the operation of the infrastructure. One user service bundle relates to vehicle oriented services. There is a commercial vehicle bundle, but it is focused on the interaction of commercial vehicles with public authorities, rather than such activities as fleet management.

| User service bundle | User service |
|--|--|
| Traveller information Services | <ul style="list-style-type: none"> ■ Pre-trip Information ■ On-trip Information ■ Travel Services Information ■ Route Guidance and Navigation – Pre-trip ■ Route Guidance and Navigation – On-trip ■ Trip Planning Support |
| Traffic Management and Operations Services | <ul style="list-style-type: none"> ■ Traffic Management and Control ■ Transport Related Incident Management ■ Demand Management ■ Transport Infrastructure Maintenance Management ■ Policing/Enforcement |
| Vehicle Services | <ul style="list-style-type: none"> ■ Vision Enhancement ■ Automated Vehicle Operation ■ Collision Avoidance ■ Safety Readiness ■ Pre-crash Restraint |
| Freight Transport Services | <ul style="list-style-type: none"> ■ Commercial Vehicle Pre-clearance ■ Commercial Vehicle Administrative Processes ■ Automated Roadside Safety Inspection ■ Commercial Vehicle On-board Safety Monitoring ■ Freight Transport Fleet Management ■ Intermodal Information Management ■ Management and Control of Intermodal Centres ■ Management of Dangerous Freight |
| Public Transport Services | <ul style="list-style-type: none"> ■ Public Transport Management ■ Demand Responsive and Shared Transport |
| Emergency Services | <ul style="list-style-type: none"> ■ Transport Related Emergency Notification and Personal Security ■ After Theft Vehicle Recovery ■ Emergency Vehicle Management ■ Hazardous Materials and Incident Notification |
| Transport-related Electronic Payment Services | <ul style="list-style-type: none"> ■ Transport-related Electronic Financial Transactions ■ Integration of Transport Related Electronic Payment Services |
| Road Transport Related Personal Safety | <ul style="list-style-type: none"> ■ Public Travel Security ■ Safety Enhancements for Vulnerable Road Users ■ Safety Enhancements for Disabled Road Users ■ Safety Provisions for Pedestrians Using Intelligent Junctions and Links |
| Weather and Environmental Conditions Monitoring Services | <ul style="list-style-type: none"> ■ Weather Monitoring ■ Environmental Conditions Monitoring |
| Disaster Response Management and Coordination Services | <ul style="list-style-type: none"> ■ Disaster Data Management ■ Disaster Response Management ■ Coordination With Emergency Agencies |
| National Security Services | <ul style="list-style-type: none"> ■ National Security Services ■ Monitoring and Control of Suspicious Vehicles ■ Utility, Structures and Pipeline Monitoring |

ITS Functions (applications)

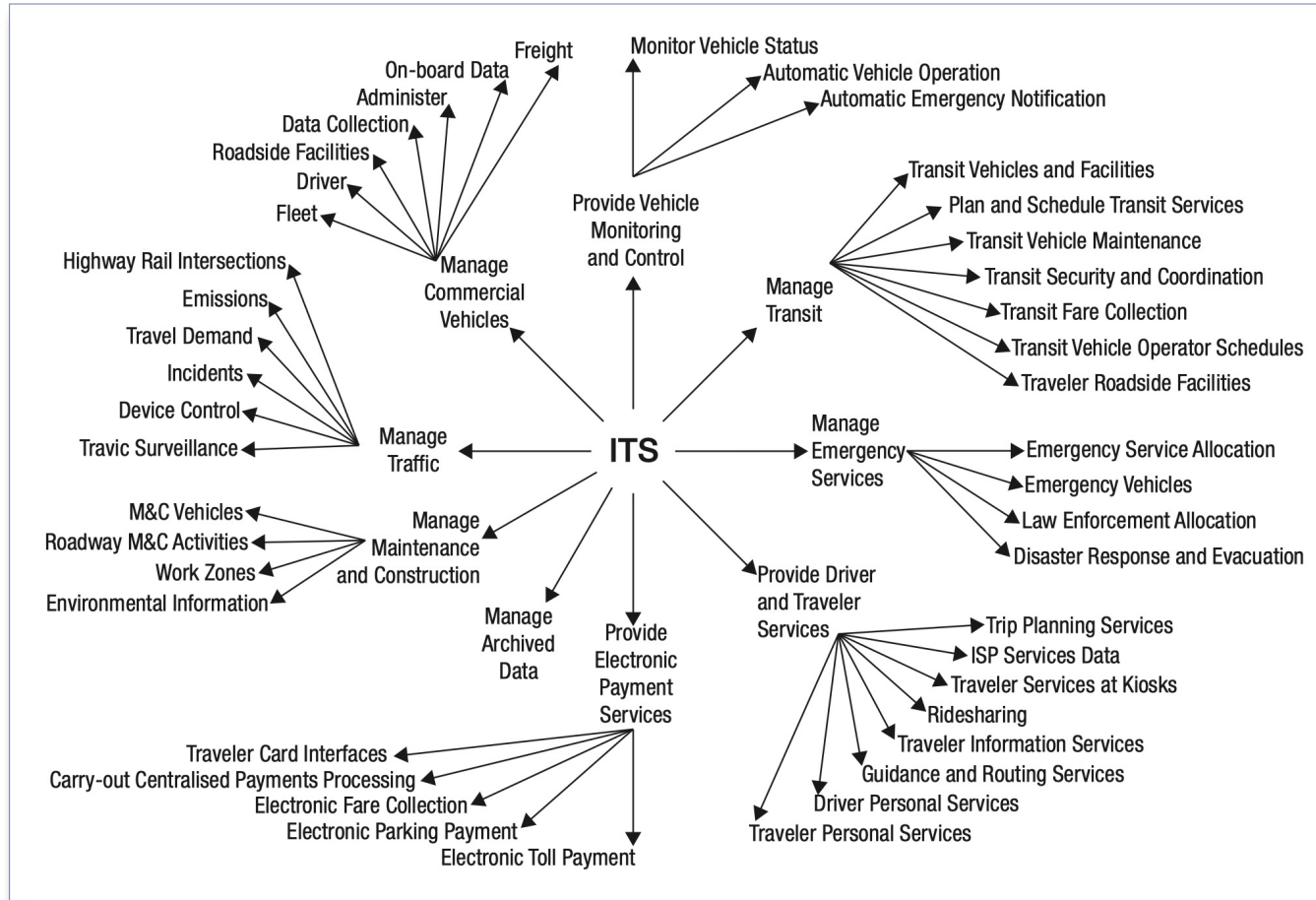

INTERNATIONAL
STANDARD

ISO
14813-1

First edition
2007-02-15

**Intelligent transport systems —
Reference model architecture(s) for the
ITS sector —**

**Part 1:
ITS service domains, service groups and
services**

| Service domain | Service group | Example services |
|--|---|--|
| 1. Traveller information | 1.1 Pre-trip information | <i>Pre-trip information – Traffic and roadway</i> |
| | | <i>Pre-trip information – Public transport (bus and rail)</i> |
| | | <i>Pre-trip information – Commercial vehicle</i> |
| | | <i>Pre-trip information – Personal interactive</i> |
| | | <i>Pre-trip information – Modal changes and multi-modal information</i> |
| | 1.2 On-trip information | <i>On-trip information – Roadside</i> |
| | | <i>On-trip information – In-vehicle signing</i> |
| | | <i>On-trip information – Public transport vehicle</i> |
| | | <i>On-trip information – Parking information</i> |
| | | <i>On-trip information – Mobile devices</i> |
| | | |
| | 1.3 Route guidance and navigation – Pre-trip | <i>Dynamic in-vehicle route guidance and navigation programming/setup</i> |
| | | <i>Integrated multi-modal trip guidance</i> |
| | | <i>Pedestrian and bicycle route guidance</i> |
| | 1.4 Route guidance and navigation – On-trip | <i>Autonomous in-vehicle navigation</i> |
| | | <i>Dynamic in-vehicle route guidance and navigation (based on real-time network information)</i> |
| <i>Integrated multi-modal trip guidance</i> | | |
| <i>Pedestrian and bicycle route guidance</i> | | |
| 1.5 Trip planning support | <i>Individual trip planning</i> | |
| | <i>Centralized trip planning</i> | |
| | <i>Data archiving</i> | |
| | <i>Data warehouse</i> | |
| 1.6 Travel services information | <i>Travel services information – In-vehicle</i> | |
| | <i>Travel services information – Personal interactive</i> | |
| | <i>Travel services information – Dedicated location</i> | |



| Service domain | Service group | Example services |
|--|---|---|
| 2. Traffic management and operations | 2.1 Traffic management and control | Traffic monitoring |
| | | Surface street control |
| | | Freeway traffic control |
| | | Preferential treatment for specific vehicle types (signal priority and pre-emption) |
| | | Reversible lane management |
| | | Coordination of surface street and freeway control |
| | | Intermodal highway junction management |
| | | Parking management |
| | | Work zone traffic management |
| | | Traffic information dissemination |
| | 2.2 Transport-related incident management | Incident monitoring and confirmation |
| | | Incident on-site motorist assistance |
| | | Incident on-site traveller assistance |
| | | Incident coordination and clearance |
| | | Hazardous materials monitoring and management |
| | 2.3 Demand management | Variable road pricing |
| | | Access management |
| | | High-occupancy lane management |
| | | Air quality-based transport management |
| | 2.4 Transport infrastructure maintenance management | Roadway construction and maintenance management |
| Winter maintenance | | |
| Pavement management | | |
| Automated road management | | |
| Work zone safety management | | |
| 2.5 Policing/enforcing traffic regulations | | Access control |
| | High-occupancy vehicle facility usage | |
| | Parking regulation enforcement | |
| | Speed limit enforcement | |
| | Signal enforcement (e.g. red light violation) | |
| | Emissions monitoring | |

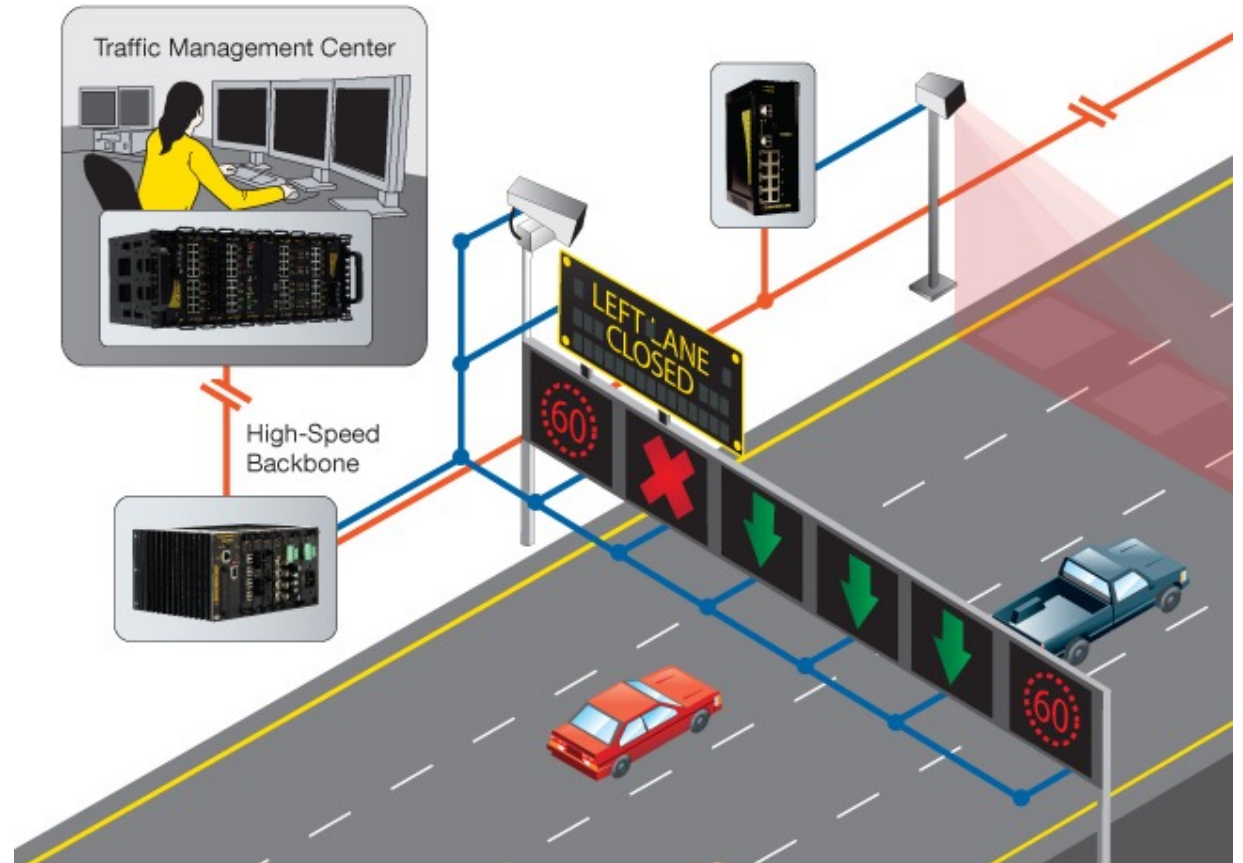

Traffic Management Centres





| Service domain | Service group | Example services |
|--|---|--|
| 3. Vehicle | 3.1 Transport-related vision enhancement | <i>In-vehicle driver vision management</i> |
| | 3.2 Automated vehicle operation | <i>Automated highway operation</i> |
| | | <i>Automated low-speed manoeuvring</i> |
| | | <i>Precision docking for public transport vehicles</i> |
| | | <i>Automated cruise control</i> |
| | 3.3 Collision avoidance | <i>Longitudinal collision avoidance</i> |
| <i>Lateral collision avoidance</i> | | |
| <i>Intersection collision avoidance</i> | | |
| 3.4 Safety readiness | <i>Vehicle internal systems monitoring</i> | |
| | <i>Vehicle external conditions monitoring</i> | |
| 3.5 Pre-crash restraint deployment | <i>Pre-crash restraint deployment</i> | |
| 4. Freight transport | 4.1 Commercial vehicle pre-clearance | <i>Weigh-in-motion</i> |
| | | <i>Non-stop pre-clearance</i> |
| | | <i>Vehicle safety records monitoring</i> |
| | 4.2 Commercial vehicle administrative processes | <i>Automated credential filing</i> |
| | | <i>Automated commercial vehicle administration</i> |
| | 4.3 Automated roadside safety inspection | <i>Automated border crossings</i> |
| | | <i>Remote access to commercial vehicle safety data</i> |
| 4.4 Commercial vehicle onboard safety monitoring | <i>Commercial vehicle internal systems monitoring</i> | |
| | <i>Commercial vehicle driver alertness monitoring</i> | |
| 4.5 Freight transport fleet management | <i>Commercial vehicle fleet tracking</i> | |
| | <i>Commercial vehicle fleet dispatching</i> | |
| | <i>Freight container tracking</i> | |
| 4.6 Intermodal information management | <i>Vehicle and container arrival information exchange</i> | |
| | <i>Customer freight information access</i> | |

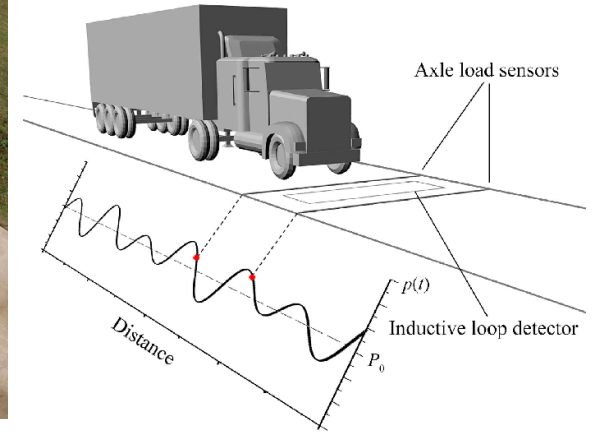

| Service domain | Service group | Example services |
|---------------------|--|--|
| | 4.7 Management and control of intermodal centres | <i>Intermodal centre facility management</i> <i>Intermodal vehicle and container control</i> |
| | 4.8 Management of dangerous freight | <i>Dangerous goods movement data sharing</i> <i>Dangerous goods movement data registry</i> <i>Dangerous goods movement fleet coordination</i> <i>Dangerous goods movement police/safety coordination</i> |
| 5. Public transport | 5.1 Public transport management | <i>Public transport vehicle internal systems monitoring</i> <i>Public transport vehicle fleet tracking</i> <i>Public transport scheduling services</i> <i>Public transport service dispatch</i> <i>Public transport service planning</i> |
| | 5.2 Demand responsive and shared transport | <i>Paratransit fleet dispatch</i> <i>Dynamic ridesharing</i> |
| | 6.1 Transport-related emergency notification and personal security | <i>Automated emergency call and mayday dispatch</i> <i>Automated vehicle intrusion and stolen vehicle monitoring</i> |
| 6. Emergency | 6.2 After-theft vehicle recovery | <i>User-initiated distress calls</i> <i>Automated theft warning</i> <i>Automated vehicle intrusion and stolen vehicle monitoring</i> <i>Stolen vehicle tracking</i> <i>Remote vehicle immobilization</i> |
| | 6.3 Emergency vehicle management | <i>Emergency vehicle fleet tracking</i> <i>Emergency vehicle traffic management coordination</i> |
| | 6.4 Hazardous materials and incident notification | <i>HAZMAT vehicle tracking</i> <i>Automated HAZMAT emergency call/mayday notification</i> <i>HAZMAT pre-clearance services</i> |
| | | |

Emotion's a state-of-the-art public transportation system enabled government, bus operator and public to maximizes the convenience of bus use by improving operation management such as bus intervals and timeliness.

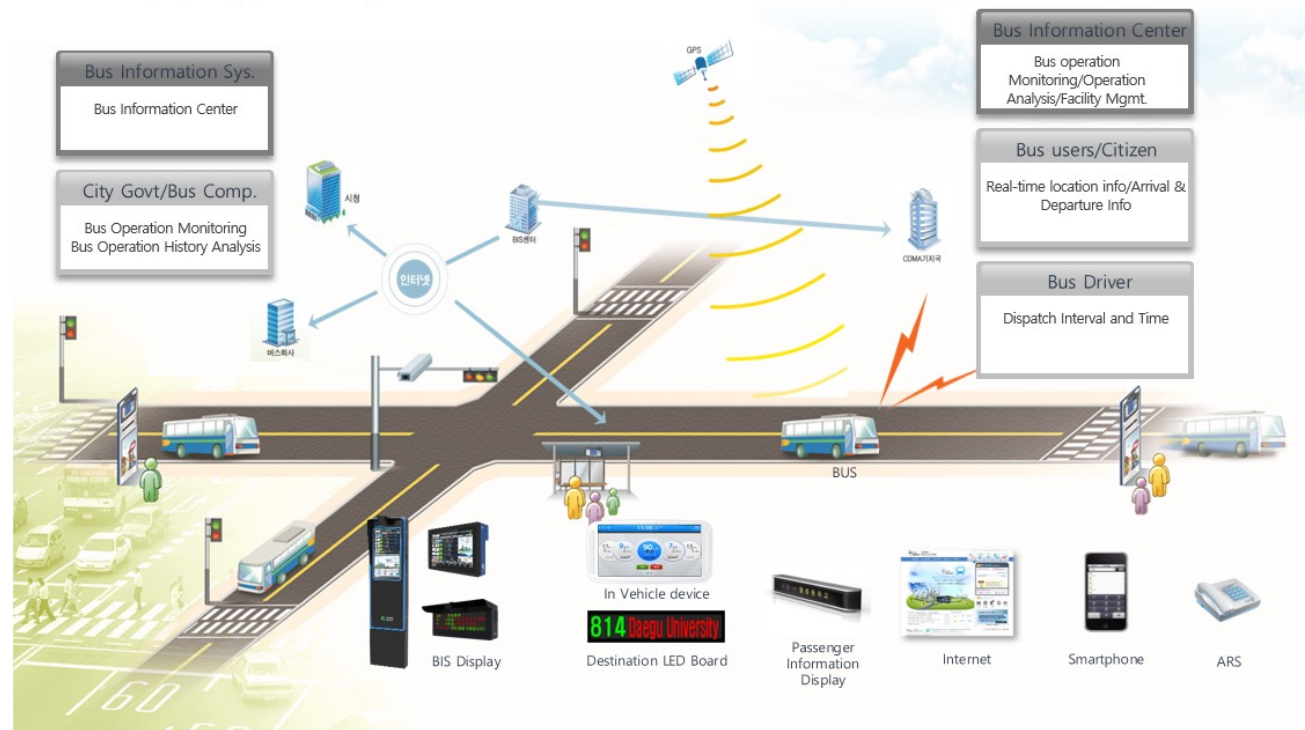

| Service domain | Service group | Example services | |
|--|---|---|--|
| 7. Transport-related electronic payment | 7.1 Transport-related electronic financial transactions | Electronic transit fare payment | |
| | | Electronic toll collection | |
| | | Electronic parking payment | |
| | | Electronic services payment (e.g. traveller information, reservations) | |
| | 7.2 Integration of transport-related electronic payment services | Electronic distance-based road user fee payment services | |
| | | Integration of multi-jurisdictional electronic payment systems | |
| | | Integration of regional multi-modal payment systems | |
| 8. Road transport-related personal safety | 8.1 Public travel security | Silent alarm | |
| | | Emergency call/mayday alert for public transport | |
| | | Intrusion detection | |
| | | Public transport surveillance | |
| | 8.2 Safety enhancements for vulnerable road users | 8.2 Safety enhancements for vulnerable road users | Non-motorized vehicle and pedestrian monitoring systems |
| | | | Systems to monitor specialized vehicles |
| | 8.3 Safety enhancements for disabled road users | 8.3 Safety enhancements for disabled road users | Intersection monitoring of specialized conveyances (e.g. wheelchairs, carts) |
| | | | Driver warnings for specialized conveyances |
| | 8.4 Safety provisions for pedestrians using intelligent junctions and links | 8.4 Safety provisions for pedestrians using intelligent junctions and links | Signal display advance warning |
| | | | Oncoming vehicle advance warning (for non-signalized junction) |
| | | | In-vehicle signage and warning systems |
| | | | |
| 9. Weather and environmental conditions monitoring | 9.1 Weather monitoring | Road weather information monitoring | |
| | | Road weather prediction | |
| | 9.2 Environmental conditions monitoring | 9.2 Environmental conditions monitoring | Water level/tidal monitoring and prediction |
| | | | Seismic monitoring |
| | | Pollution monitoring | |
| | | Avalanche, mud slide and fallen rock monitoring | |

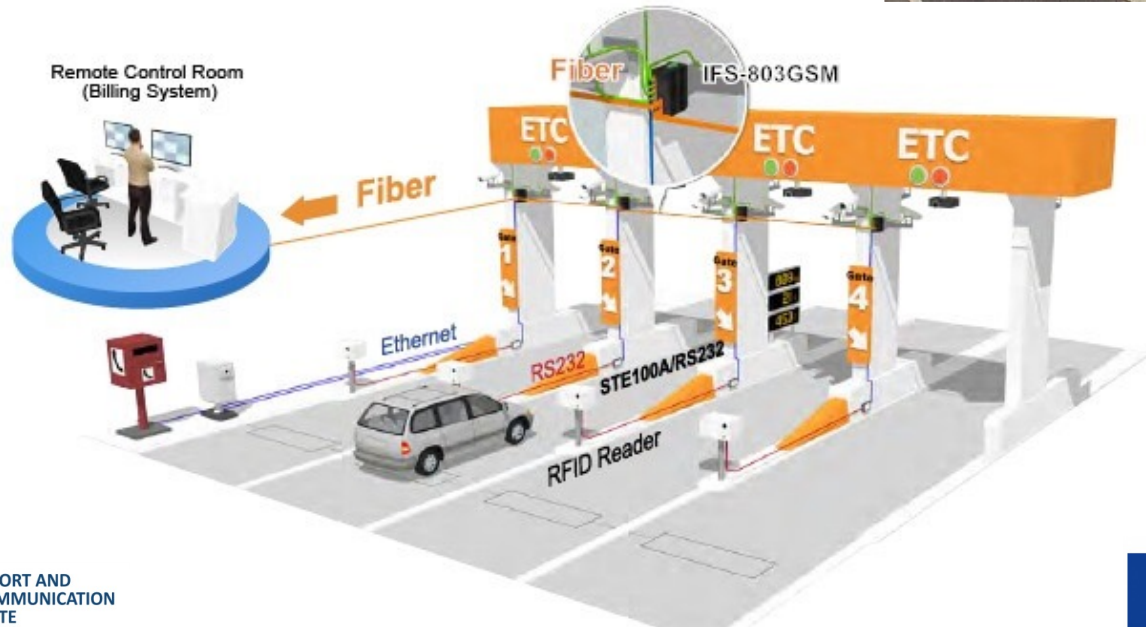

| Service domain | Service group | Example services |
|---|---|---|
| 10. Disaster response management and coordination | 10.1 Disaster data management | <i>Disaster and emergency data collection</i> |
| | | <i>Disaster and emergency data sharing</i> |
| | 10.2 Disaster response management | <i>Disaster response planning for the transport network</i> |
| | | <i>Disaster response implementation</i> |
| | 10.3 Coordination with emergency agencies | <i>Disaster response coordination</i> |
| | 11. National security | 11.1 Monitoring and control of suspicious vehicles |
| <i>Vehicle disablement</i> | | |
| <i>Road traffic management</i> | | |
| <i>Identification of suspicious vehicles</i> | | |
| 11.2 Utility or pipeline monitoring | | <i>Pipeline and utility HAZMAT/explosives monitoring</i> |
| | | <i>Emergency notification to key agencies</i> |
| 12. ITS Data Management | 12.1 Data registries | <i>Registration of ITS data concepts and subroutines for re-use and interoperability</i> |
| | 12.2 Data dictionaries | <i>Local registration of ITS data concepts and subroutines for re-use and interoperability</i> |
| | 12.3 Emergency messages | <i>Registration of emergency related messages, both originated from vehicles and from transport system users via portable or other devices, to provide interpretable data to assistance providers that is relevant to the emergency</i> |
| | 12.4 Control centre data | <i>Registration of data concepts that may be exchanged between control centres</i> |
| | 12.5 Enforcement | <i>Data storage and exchange for law enforcement</i> |
| | 12.6 Traffic management data | <i>Data storage and exchange for use within and between traffic management centres, road operators, government agencies, law enforcement and emergency services</i> |



Advanced Driver Assistance System

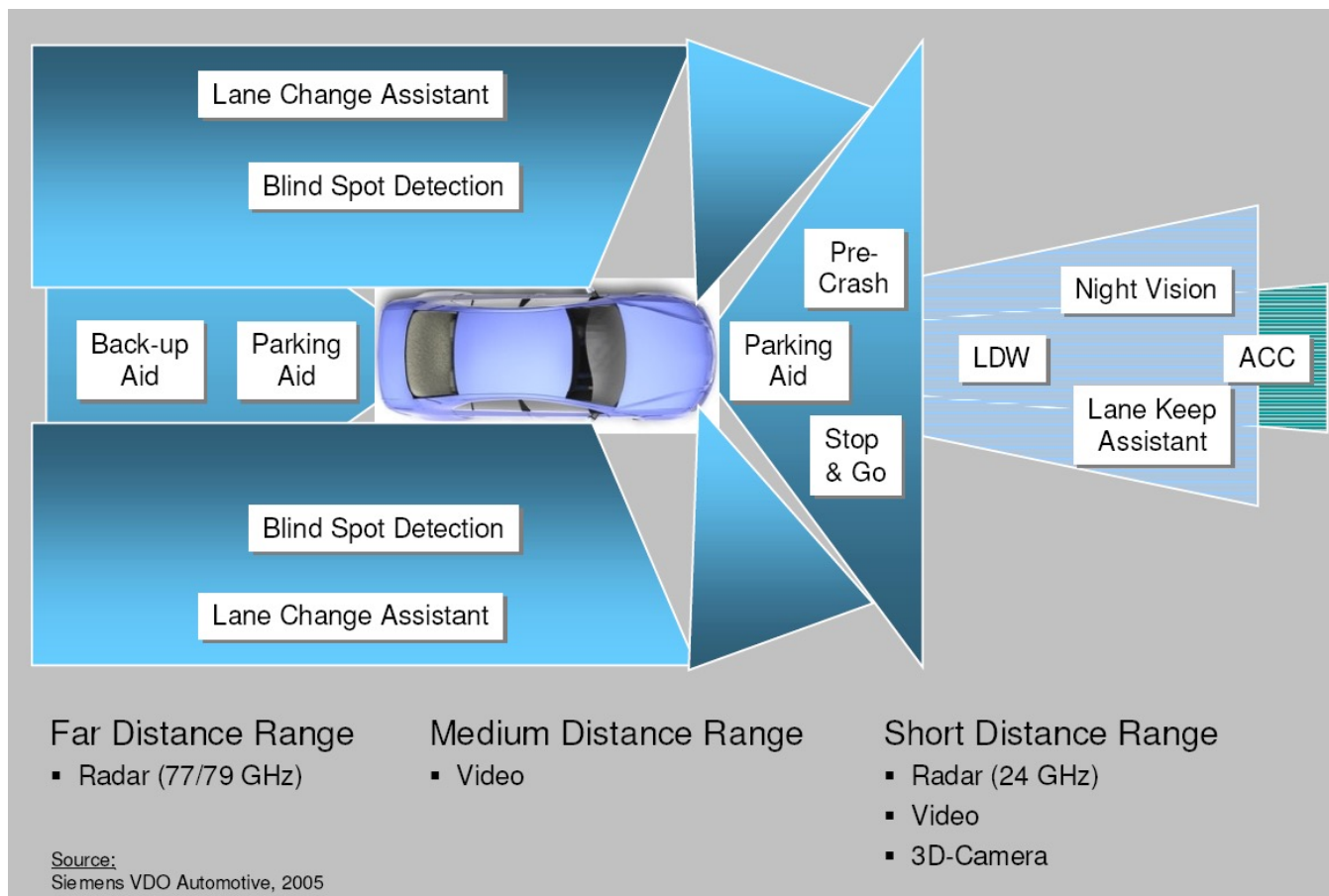

Examples of driver assistance systems

Longitudinal control



City Break Assist
Front Assist

Lateral control

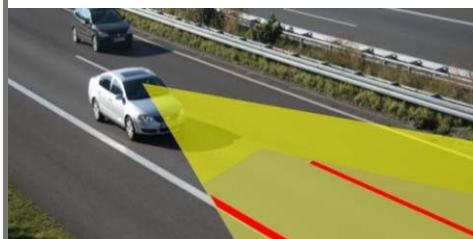

Side Assist
Lane Assist

Park assist systems



Park Assist

Light



Light Assist

Recommendation



Pause
Recommendation

Driver information



Sign Assist

Future trends of ITS

TOMORROW STARTS NOW

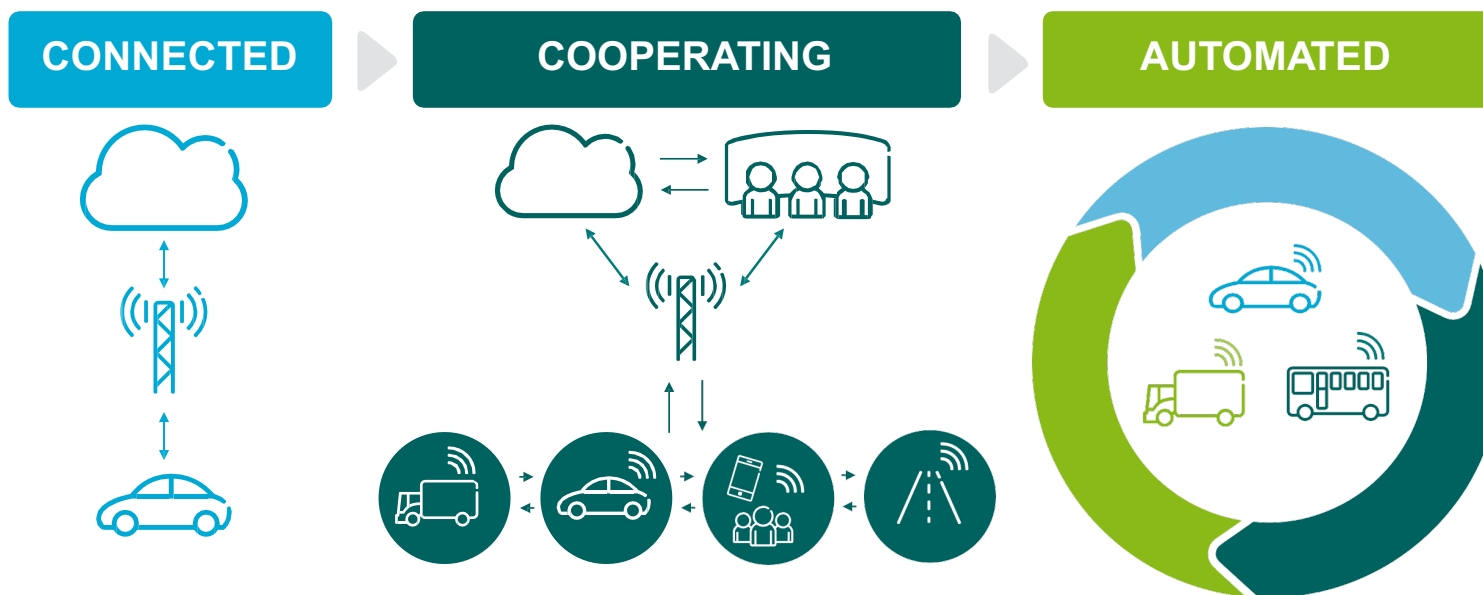

Source: Ericsson, 2014

Cooperative Intelligent Transport Systems and Services (C-ITS) refers to transport systems, where the cooperation between two or more ITS sub-systems (personal, vehicle, roadside and central) enables and provides an ITS service that offers better quality and an enhanced service level, compared to the same ITS service provided by only one of the ITS sub-systems.

According to the C-ITS Deployment Platform having been organised by the European Commission, cooperative Intelligent Transport Systems (C-ITS) shall use mature ad-hoc short-range (like ETSI ITS G5) and complementing wide-area communication technologies (like 3G, 4G, future 5G) that allow road vehicles to communicate with other vehicles, traffic signals, roadside infrastructure and other road users.

The cooperative **V2X** systems are also known as vehicle-to-vehicle communications (**V2V**), vehicle-to-infrastructure communications (**V2I**) or vehicle-to-person (**V2P**) communications. In summary, the wireless data exchange between the different actors and ITS stations and related functions are named cooperative V2X communication. It supports a number of information, warning and assistance services which will be gradually deployed in coordinated innovation phases during the oncoming years.

Cooperation and Communication

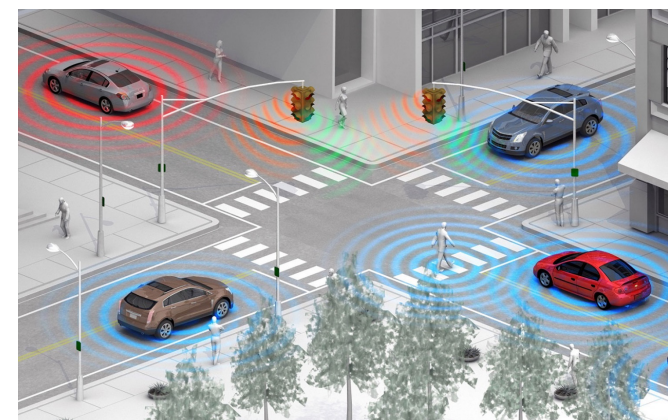
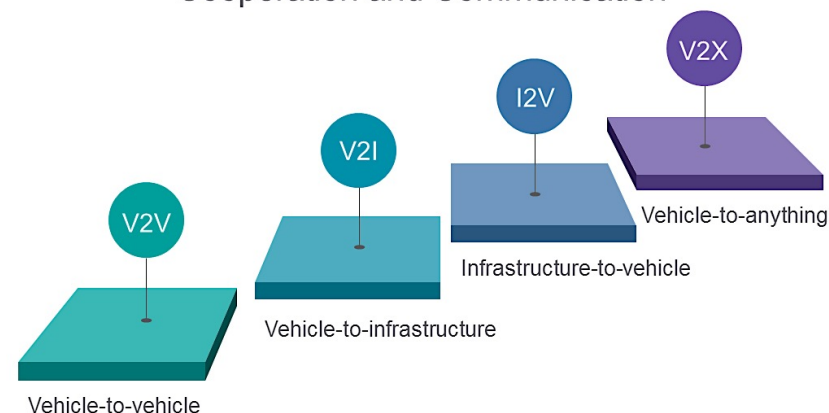

V2X = V2V + V2I + V2P

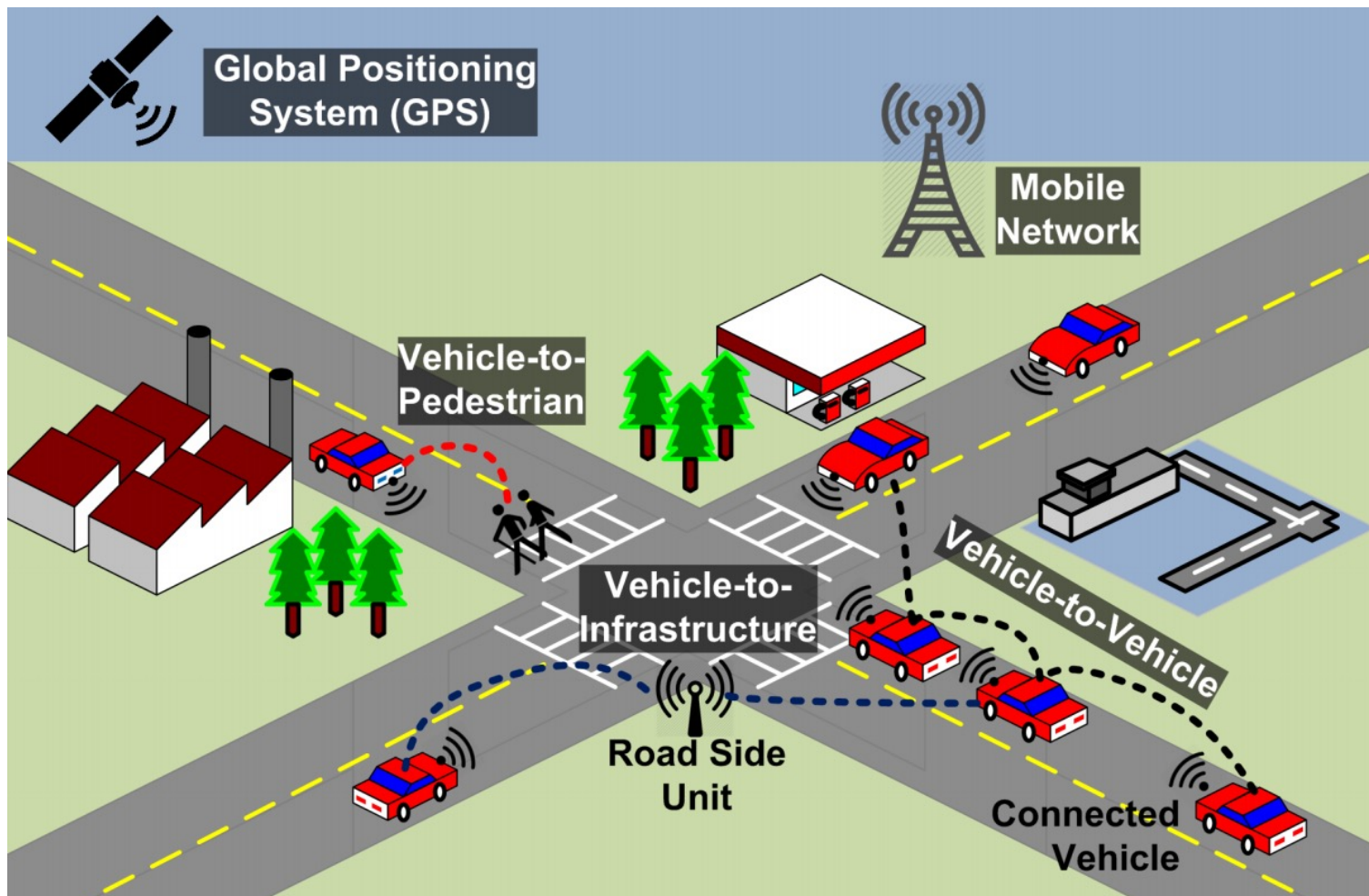

ITS enabled by Mobile Broadband and cloud

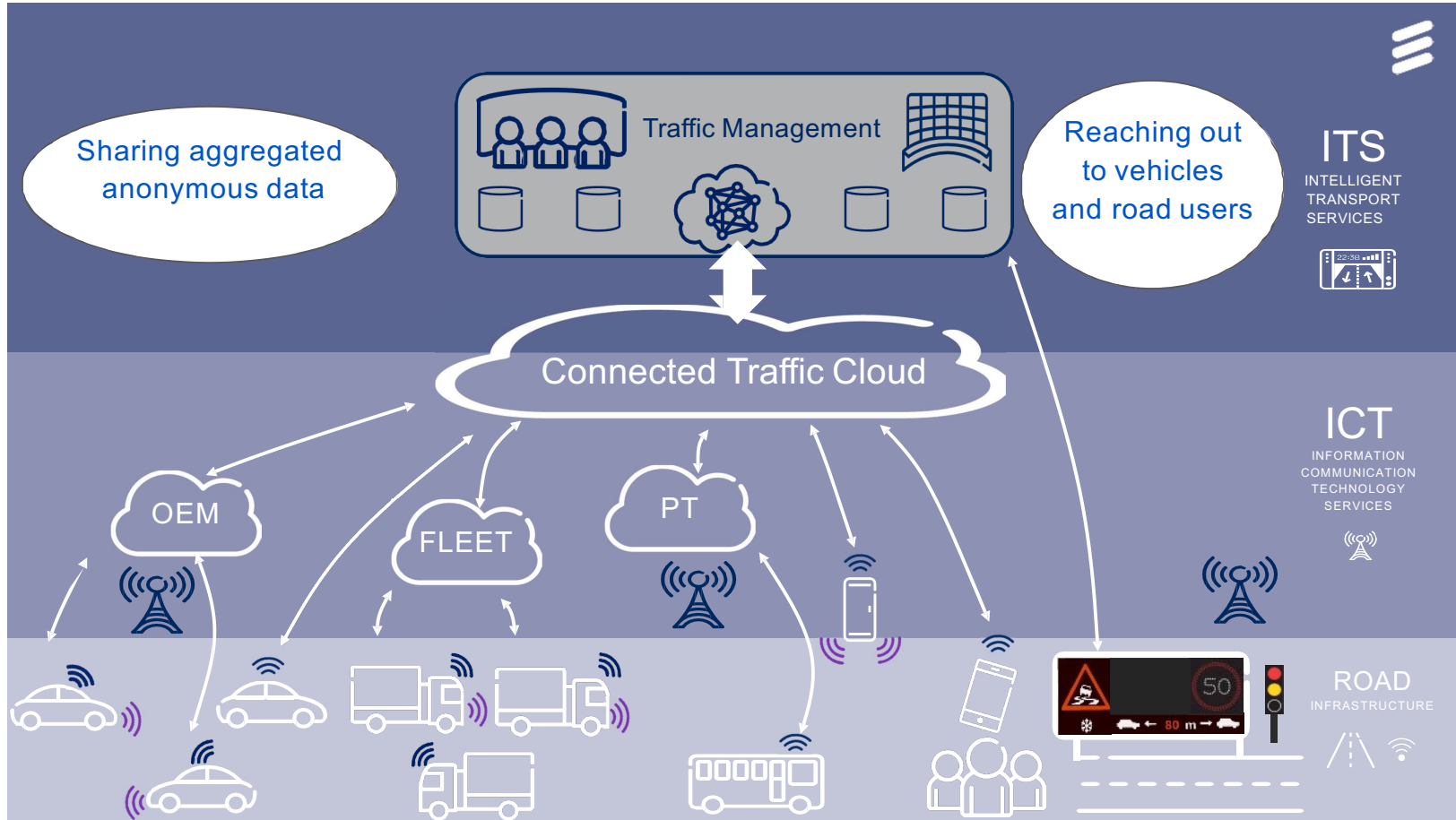

Topic 3. ITS and C-ITS applications and user services



Intelligent Transportation Systems

Igor Kabashkin (kiv@tsi.lv)

Professor, Dr.hab.sc.ing.

Transport and Telecommunication Institute (Riga, Latvia)